

REELL WRAP SPRING SLIP CLUTCH

SHAFT NOM.	DIA. "A"	DESCRIPTION: SB-Nm-DIR-BORE 6mm BORE SHOWN THREE DOG SHAFT THREE DOG DRIVE HUB CURRENT TORQUES AVAILABLE
1/4	.2505/.2580	SLIP TORQUE: [0.1 N-m] 0.88 Lb-in ±20%
6mm	[6.01/6.2]	SLIP TORQUE: [0.2 N-m] 1.77 Lb-in ±20%
8mm & 5/16	[8.01/8.2] & .3153/.3230	SLIP TORQUE: [0.4 N-m] 3.54 Lb-in ±20%
		SLIP TORQUE: [0.7 N-m] 6.2 Lb-in ±20%

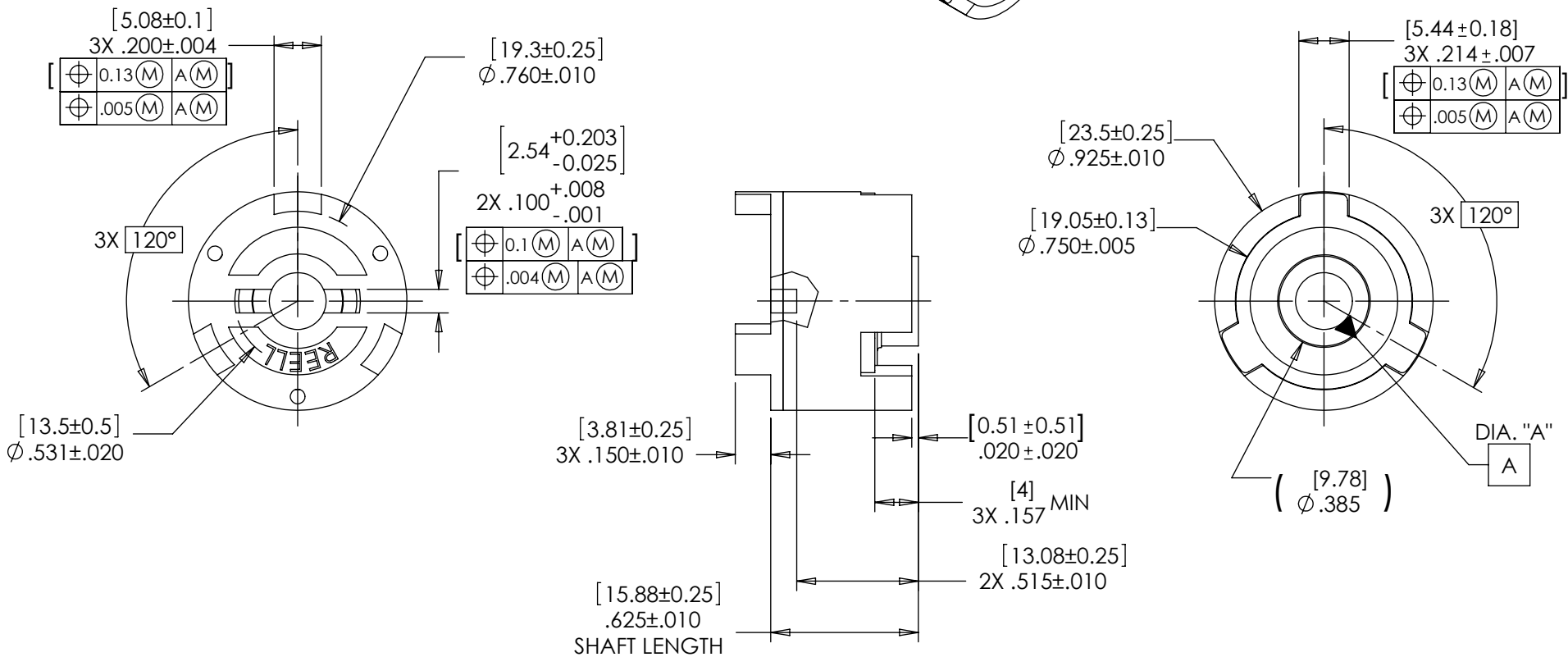
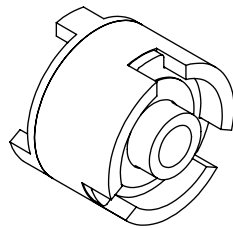

SPECIFICATIONS SUBJECT TO CHANGE

CONSISTENT WITH  
ASME Y14.5M-1994  
THIS PRINT IS THE  
CONFIDENTIAL PROPERTY  
OF REELL PRECISION MFG.

THIRD ANGLE PROJECTION

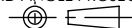

LEVEL	DESCRIPTION	DRAWN	DATE	APPROVED
DRAWN: DDF	DATE: 2-7-96	PART NO: 44-XXX		
CHECKED: DDF	DATE: 3-27-97	TITLE: HIGH INERTIA SLIP DEVICE		
APPROVED: DDF	DATE: 3-27-97	DESCRIPTION: SB		
REVISED: 9-13-13	DIMS: [mm]IN	REV: G		
REELL PRECISION MANUFACTURING 1259 WILLOW LAKE BOULEVARD SAINT PAUL, MINNESOTA 55110-5103, USA		SCALE: 1.5:1	DO NOT SCALE DRAWING	SHEET 1 OF 1

