

TORQUE [mm] INCHES	PHCS PART NO.
[0.44 Nm] 3.9 Lb-in	81001-004
[0.78 Nm] 6.9 Lb-in	81001-008
[1.22 Nm] 10.8 Lb-in	81001-012
[1.57 Nm] 13.9 Lb-in	81001-016
[2.01 Nm] 17.8 Lb-in	81001-020
[2.35 Nm] 20.8 Lb-in	81001-024
[2.79 Nm] 24.7 Lb-in	81001-030

NOTES:

- TORQUE TOLERANCE: $\pm 20\%$.
- LIFE: 50,000 CYCLES WHEN DUTY CYCLE IS LESS THAN 10% AND ROTATIONAL SPEED IS LESS THAN 100 RPM. 30 SECONDS MAXIMUM CONTINUOUS ACTUATION.
- BRACKET FLATS TO BE ORIENTED $\pm 5^\circ$ WITH RESPECT TO DATUM A AS SHOWN.
- DESIGNED TO ACCEPT M4 OR #8 SCREW OR EQUIVALENT.
- USER MUST DETERMINE FITNESS FOR USE IN APPLICATION.
- MATERIAL: 316L STAINLESS STEEL.

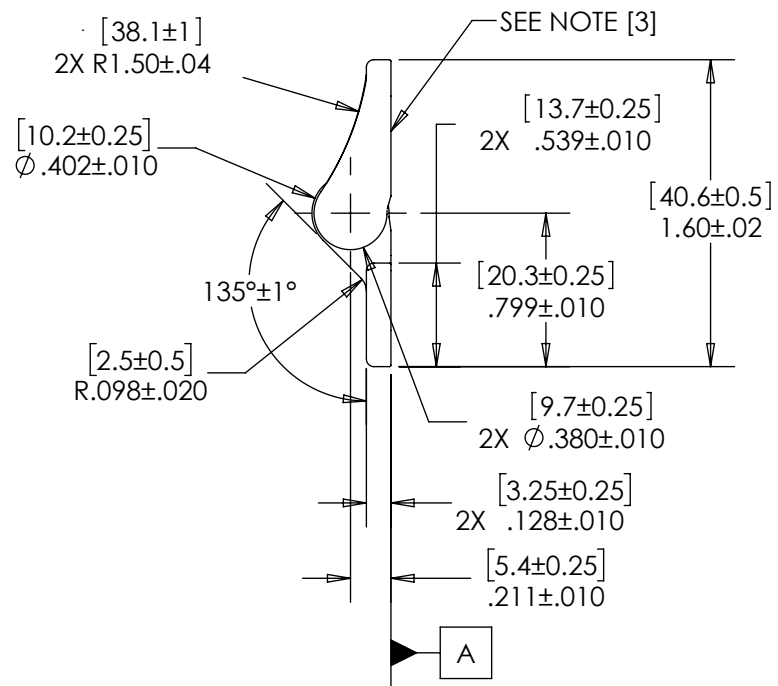
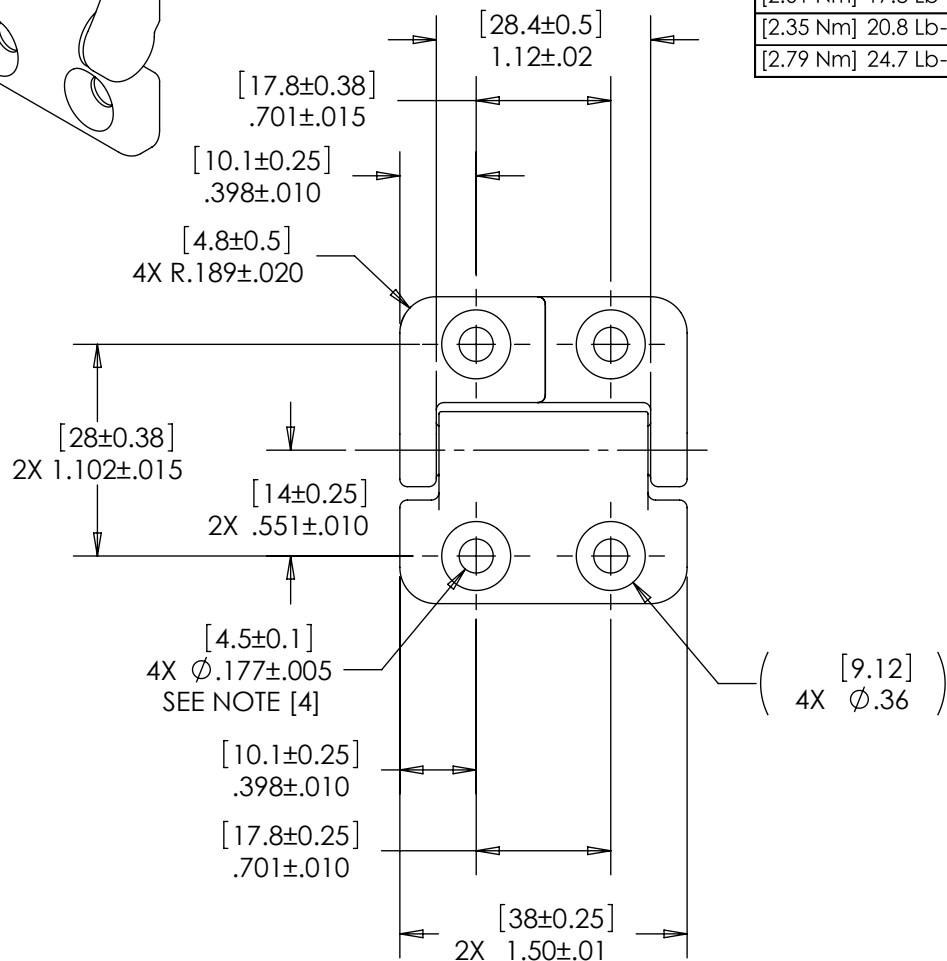

SPECIFICATIONS SUBJECT TO CHANGE

INTERPRET PRINT PER ASME Y14.5M-1994
THIS PRINT IS THE CONFIDENTIAL PROPERTY OF REELL PRECISION MFG.

THIRD ANGLE PROJECTION



REELL PRECISION MANUFACTURING
1259 WILLOW LAKE BOULEVARD
SAINT PAUL, MINNESOTA 55110-5103, USA

LEVEL	DESCRIPTION	DRAWN	DATE	APPROVED
DRAWN:	JDR	DATE:	1-22-09	PART NO: 81001-0XX
CHECKED:	TWJ	DATE:	1-23-09	
APPROVED:	TWJ	DATE:	1-23-09	
REVISED:	3-29-19	DIMS:	[mm] IN	
TITLE: STAINLESS STEEL HINGE		DESCRIPTION:		REV:
		PHCS SERIES WITH COUNTERSINKS		F
SCALE: 1:1		DO NOT SCALE DRAWING		SHEET 1 OF 1