

vTilt MOUNTING GUIDE

Reell's VESA compatible vTilt Monitor Mount allows users to easily adjust computer displays and monitors to the desired viewing angle. It securely holds monitors in any position without the need for set screws or locking mechanisms.



INSTALLATION PROCESS

Follow this simple 3-step process to correctly install the vTilt monitor mount for secure "set and forget" performance

STEP 1:

Attach vTilt to 75mm or 100mm VESA hole pattern on the monitor using (4) M4x12mm screws. The Reell logo must face upward for proper orientation.

STEP 2:

Attach the vTilt swivel axis mount using an M8 or 5/16" pan head screw and swivel thrust washers. Tighten the swivel mount screw until the desired swivel resistance is achieved.

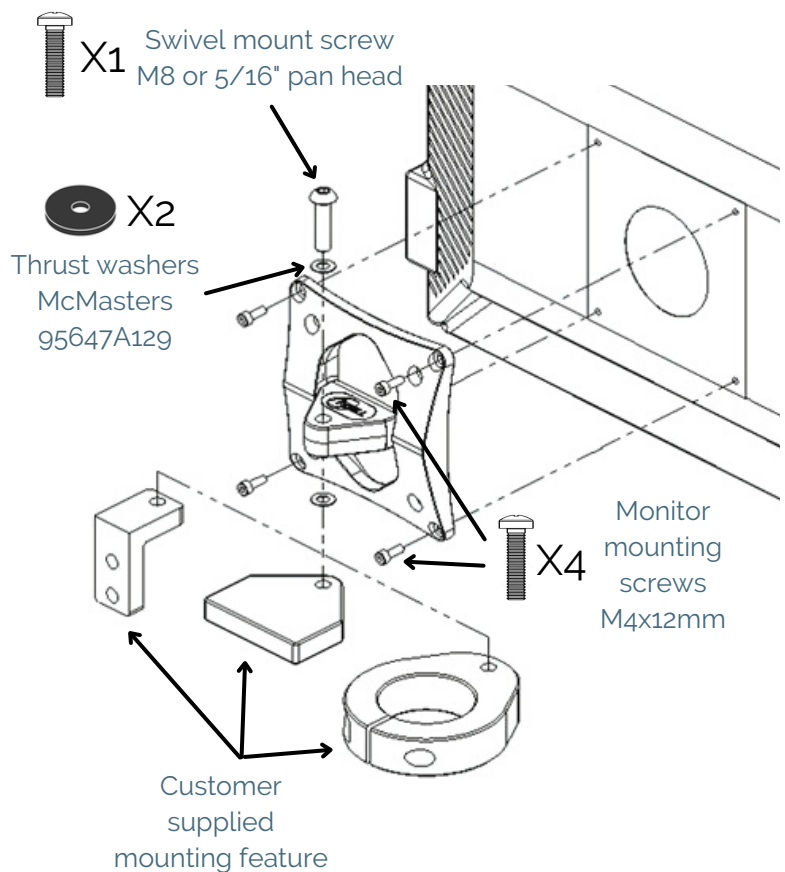

STEP 3:

Optional: Install a #8 self tapping screw into the swivel stop port to restrict the horizontal range of motion

The customer supplied mounting interface will need to have a feature for the swivel stop to contact

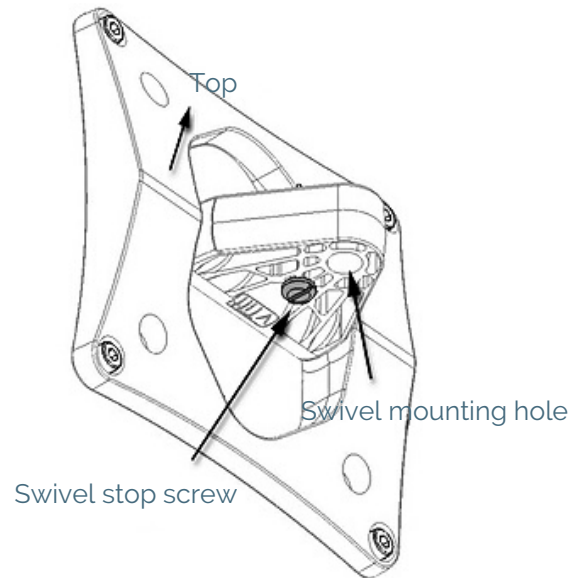

IDENTIFYING PART TORQUE

Determine vTilt torque value using the part identifier codes molded into the underside of the mounting bracket.

The three codes labeled X, Y and Z in the diagram below, have the following meanings:

X: Torque symmetry (1=differential, 5=one-way)

Y: First digit of torque specification

Z: First decimal place of torque specification

Nominal torque is read as Y.Z Nm

