

SJ SERIES INSTALLATION GUIDE



Reell's SJ family of products provide up/down, left/right, and full 360° rotation in a single device. Replace multiple components with the SJ to conserve space, improve feel, and lower total cost.

The SJ's superior long term holding power eliminates the need for secondary locking mechanism and adjustments over time.



MOUNT MAIN BODY

Follow this simple 3 step process to mount the body to any flat surface.

STEP 1:

Ensure mounting surface is flat.



STEP 2:

Determine the correct mounting hole pattern. Reference sales drawings at Reell.com/SJ.

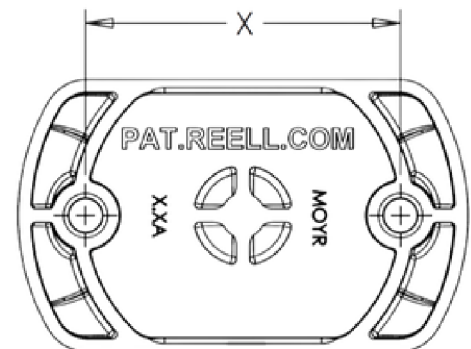

STEP 3:

Secure SJ product to mounting surface with proper socket head cap screw. Fastener thread length determined by customer, based on mounting surface and application.



Product	Thread Size
SJ200	M2.5
SJ300	M3
SJ500	M6

INSTALL THREADED SHAFT

There are two installation options, THREADED PORT or HOLE MOUNTING. Once completed, test and verify the product is secure and performs acceptably in your application.

THREADED PORT OPTION

STEP 1:

Drill and tap correct hole and mating thread for shaft end. Minimize thread chamfer to maximize available threads.

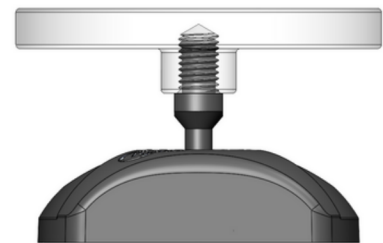

STEP 2:

Thread SJ shaft end into the port and tighten thread to the recommended torque listed below.

Product	Shaft Thread Size	Shaft Thread Length	Recommended Torque
SJ200	M4 x 0.7	4 mm	3-4 Nm
SJ300	M6 x 1 1/4"-20	9 mm 6 mm	11-15 Nm
SJ500	M10 x 1.5	13 mm	35-45 Nm

THROUGH HOLE OPTION

STEP 1:

Using the chart shown in Step 2 below, determine the appropriate hole clearance and create through hole.

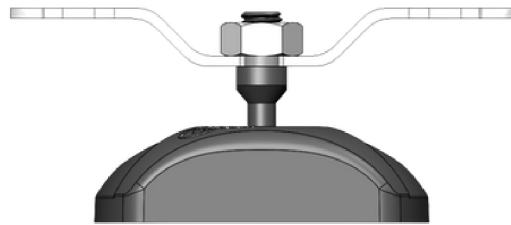

STEP 2:

Thread nut onto SJ shaft to the recommended torque listed below. Grade 5 or higher nut recommended per ISO 898-02.

Product	Clearance Hole	Recommended Torque
SJ200	4.3 mm	3-4 Nm
SJ300	6.4 mm	11-15 Nm
SJ500	10.5 mm	35-45 Nm

ADDITIONAL NOTES AND GUIDELINES

1. Product recommendations and installation instructions provided as general guidance. Because many factors may impact final product performance, Reell strongly advises customers to test our product in their end use application to confirm acceptable performance.
2. For maximum application load recommendations, contact Reell at info@reell.com.
3. SJ300 and SJ500 provide asymmetric torque, with a higher torque in one direction. In lighter weight applications, such as a tablet or camera, mount the higher torque in the left to right direction or inline with the larger dimension. In heavier applications or designs with longer moment arms orient the higher torque in the up and down direction.
4. Additional dimensions, technical details and warranty statement can be found for this and other products at Reell.com.

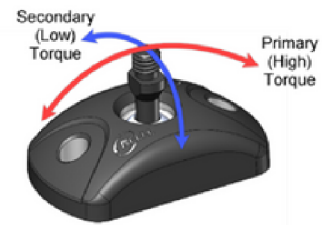

SJ300 HIDDEN MOUNT OPTION:

Reference SJ300 sales drawing for correct mounting hole location, specification, and screw size.

Install self-tapping threaded fastener through mounting surface into SJ product. Ensure thread length provides acceptable thread engagement and does not break through housing.

Note: some larger M5 (or english equivalent) screws may be used. Customer responsible for fitness for use.

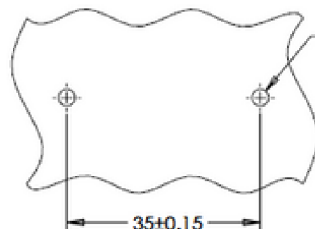
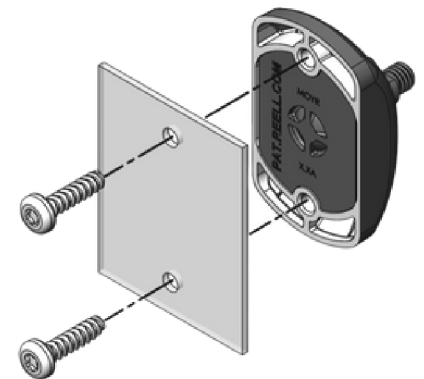

CLEARANCE HOLES FOR M4.5 (OR ENGLISH EQUIVALENT) THREAD-FORMING SCREW DESIGNED FOR PLASTIC. MINIMUM RECOMMENDED ENGAGEMENT DEPTH 5.6 mm.

