

REELL WRAP SPRING SLIP CLUTCH

SHAFT NOM.	DIA. "A"	DESCRIPTION: SA-Nm-DIR-BORE 6mm BORE SHOWN
1/4	.2505/.2550	THREE DOG SHAFT
6mm	[6.01/6.13]	THREE DOG DRIVE HUB
8mm & 5/16	[8.02/8.18] .3157/.3220	CURRENT TORQUES AVAILABLE SLIP TORQUE: [0.2 N-m] 1.77 Lb-in ±20% SLIP TORQUE: [0.4 N-m] 3.54 Lb-in ±20% SLIP TORQUE: [0.8 N-m] 7.08 Lb-in ±20% SLIP TORQUE: [0.95 N-m] 8.41 Lb-in ±20%

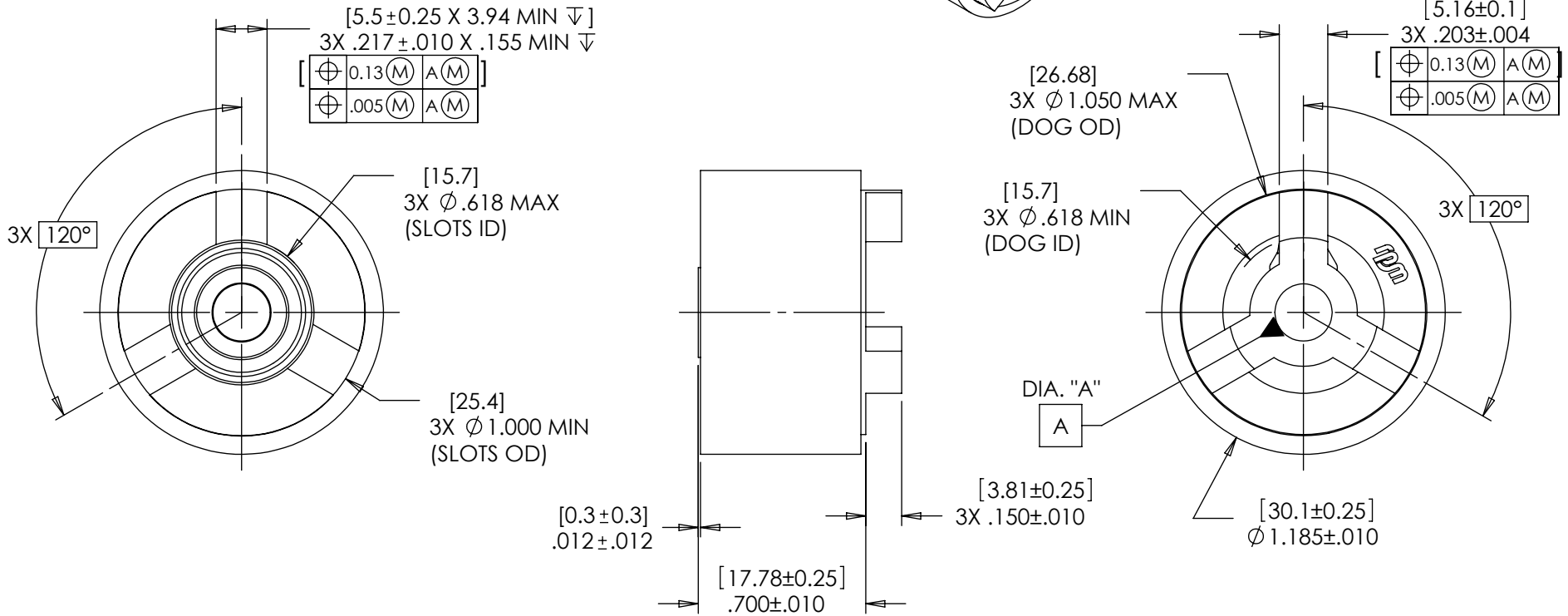
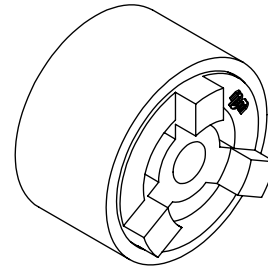

LEVEL	DESCRIPTION		DRAWN	DATE	APPROVED
DRAWN:	DMT	DATE: 7-19-88	PART NO: 84-XXX		
CHECKED:	GDL	DATE: 10-5-88	TITLE: HIGH INERTIA SLIP DEVICE		
APPROVED:	GDL	DATE: 10-5-88	DESCRIPTION: SA		
REVISED:	9-13-13	DIMS: [mm]IN	REV: J		
CONSISTENT WITH ASME Y14.5M-1994 THIS PRINT IS THE CONFIDENTIAL PROPERTY OF REELL PRECISION MFG.				SCALE: 1.5:1 DO NOT SCALE DRAWING	
THIRD ANGLE PROJECTION 		REELL PRECISION MANUFACTURING 1259 WILLOW LAKE BOULEVARD SAINT PAUL, MINNESOTA 55110-5103, USA		SHEET 1 OF 1	